

ADDING TODAY'S NEW REPAIR ORDERS TO YOUR DASHBOARD

Follow the steps below to create a visual report graphic showing the current day's New Repair Orders.

From the Home Page; Select an existing Dashboard by clicking on the far-right caret next to Unassigned Reports (or the current Dashboard name), or create a new Dashboard by clicking [**New**].

Click the [**Add Report**] button in the Action Ribbon.

ON THE REPORT TAB

1. **Report Basis** - Select [Service Repair Orders]
2. **Report Title** - "Today's New Repair Orders"
3. **Default View** - Number

ON THE FILTERS TAB

1. Set **Background Color** - Red
2. Click [**Add Condition**]
3. Set [**Number 1**] [>] [9 or amount] [**Green**]
4. Specify Number 1 as [**Units Count**]
5. Leave **Upper Text** Blank **Lower Text** "Service Today"
6. Click [**Add Condition**]
7. [**Type**] [=] [**Service**]
8. Specify Number 2 as [**Base Set Value**] and **Value** [10 or amount]
9. Leave **Upper Text** Blank **Lower Text** "Today's Plan"

Dashboard Manager

<ul style="list-style-type: none"> Report Filters List Parameters 	<p>Background Color <input type="text" value="Red"/></p> <p>Number 1 <input type="text" value="9"/> <input type="text" value=">"/> <input type="text" value="Green"/> <input type="button" value="X"/></p> <p style="color: blue; text-decoration: underline;">Add Condition</p> <p>Number 1 <input type="text" value="Units Count"/></p> <p>Upper Text <input type="text" value=""/></p> <p>Lower Text <input type="text" value="Service Today"/></p> <p>Type <input type="text" value="="/> <input type="text" value="Service"/> <input type="button" value="X"/></p> <p style="color: blue; text-decoration: underline;">Add Condition</p> <p>Number 2 <input type="text" value="Set Value"/> Value <input type="text" value="10"/></p> <p>Upper Text <input type="text" value=""/></p> <p>Lower Text <input type="text" value="Today's Plan"/></p>
---	---

For Technical Support, please contact: 1.800.227.8187 or email dmssupport@dominiondms.com

ON THE PARAMETERS TAB

1. **Report Title** [Today's New Repair Orders]
2. **Companies** [Select Companies to include]
3. **Advisor** [All or select individual]
4. **Open Status** [All]
5. **Based On** [Open Date]
6. **Date Type** [Preset Date Range]
7. **Date Range** [Today]

Click [**Save**]

Each Dashboard may be edited by clicking on the three ellipses in the upper right corner and clicking on Settings. Contact Customer Support for details to create personalized Dashboards.

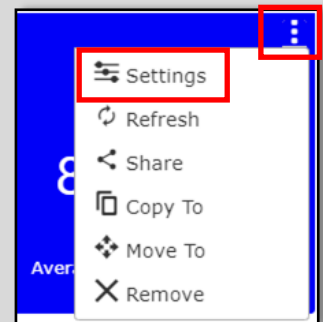

For Technical Support, please contact: 1.800.227.8187 or email dmssupport@dominiondms.com